



**NISSAN XTERRA (2002-2004)  
NISSAN FRONTIER (2002-2004)  
(Automatic and Manual Transmission)  
PART NUMBER: NS-71-02**

**PLEASE READ COMPLETE INSTRUCTIONS BEFORE INSTALLING THIS Pro.Fit VSM®.**

All instructions assume a drivers seat vantage point. Caution is advised when removing and reassembling wood or plastic parts of a dash. Applying unnecessary force or pressure may cause a piece to crack or break.

**Pro.Fit logo and part number will be right side up and readable when installed.**

**TOOLS REQUIRED:** #2 Phillips screwdriver, utility knife or Dremel® grinder, hook tools

**PARTS INCLUDED:** Pro.Fit VSM®, instructions.

**LOCATION:** Right of Radio

STEP 1. Begin by setting the parking brake. Remove the gear shift knob on vehicles with **Manual Transmission Only** by unscrewing it in a counter-clockwise direction. **Do Not** try to remove the knob in vehicles with automatic transmission. Next, remove the trim bezel that surrounds the gear shift. Insert a hook tool behind the bezel in the lower right corner. Pull up gently to release a retainer clip. Work the hook tool around the bezel until all six (6) clips are released. (See photo # 1). Lift the bezel off and set aside. Remove two (2) Phillips screws from the bottom of the radio bezel. (See photo # 1).

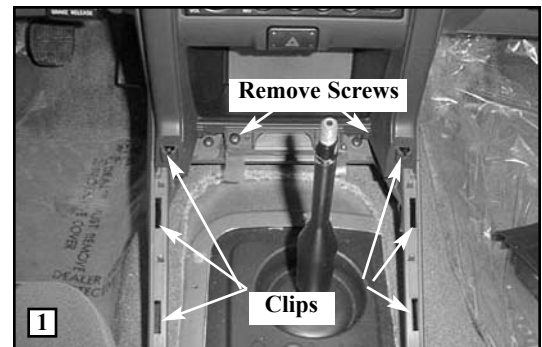

STEP 2. Remove the two (2) Phillips screws from above the radio display. (See photo # 4). Insert a hook tool behind the radio bezel, to the right of the radio. Pull out gently to release a retainer clip. (See photo # 2). Work the hook tool around the bezel until all the clips are released. Move the bezel to the left to reveal two (2) radio mounting screws. (See photo # 2). **Do Not** disconnect the wiring to the bezel. Remove the mounting screws from the right side of the radio.

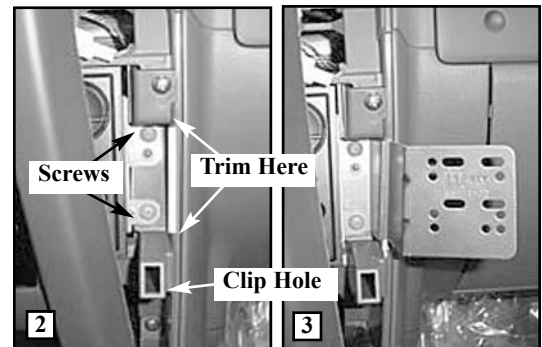

STEP 3. There is a small ridge in the dash pad to the right of the radio that is normally covered by the trim bezel. (See photo # 2). Using a utility knife or Dremel®, carefully remove this ridge. Slide the **Pro.Fit VSM®** behind the radio mounting bracket and align the **VSM®** until the screw holes align. Insert the mounting screws through the radio bracket and the **VSM®**. Reassemble the dash in reverse order.



This completes the installation of your **Pro.Fit VSM®**.

Pro.Fit International, Inc.® may not be held liable for any damage to a vehicle before, during or after the installation or removal of this Pro.Fit VSM®. Pro.Fit may not be held liable for any personal injury resulting from accident or improper installation. Pro.Fit International, Inc.® 1335 Eagandale Court, Eagan, MN 55121, Ph: 651-688-3588 or 800-388-0073 Fx: 651-688-9876

